

Recreation and Park Committee

5/23/2023

Lakeridge Park Update



Dan Efseaff

Paradise Recreation and Park District

COMING SOON!



PARADISE RECREATION & PARK DISTRICT
BRINGS YOU...

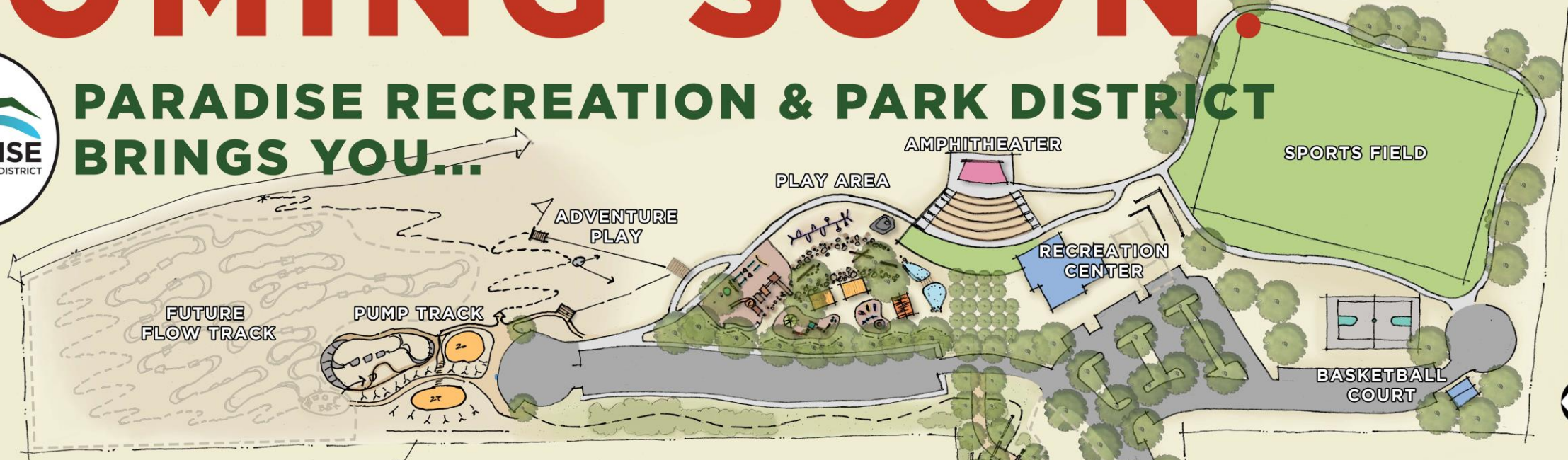

HIKING

BIKING

PLAYING

SPORTS

PICNIC

BOTANICAL GARDEN

FUTURE PLANNING AREA

TO LAKERIDGE CIRCLE

EVENTS

WATER PLAY



LAKERIDGE PARK



The Beginnings of Lakeridge Park

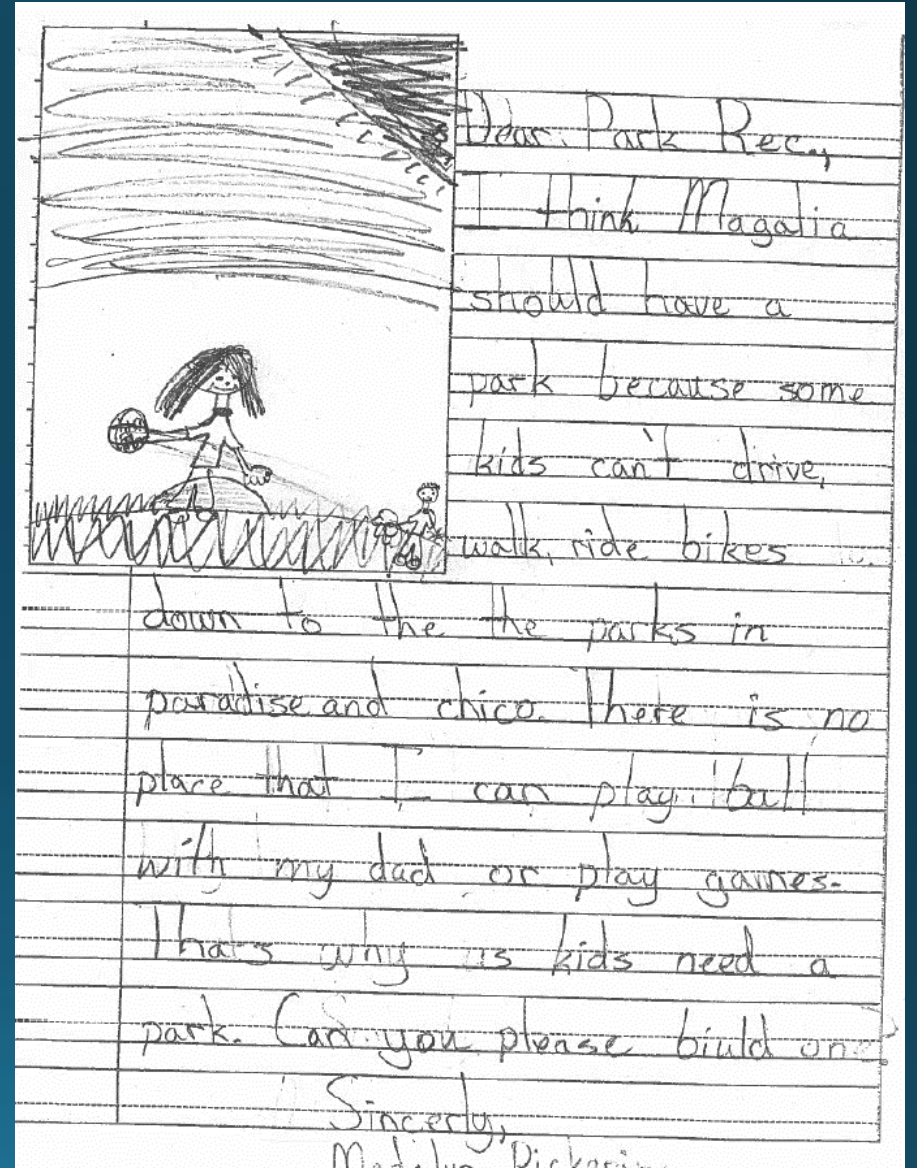

PRPD Plan

(2010 -2016 update)



- “The most pressing need for a new community center is in the Magalia area due to the concentration of population and the lack of comparable facilities. The cost to develop a community center is widely variable depending on features it contains. At a minimum, the Magalia area community center should have a large multi-purpose room, several smaller classrooms, a kitchen, restrooms, a locker room, and parking...It is suggested that enough property be acquired (8 to 10 acres minimum) to allow room for sport fields and a playground in conjunction with the community center. ”

- Master Planned Improvements \$2,4M
- Community Center: \$2.5 M to \$4.5 M
- Funding must come from Grants, partnerships, or consider benefit assessment Districts.



Paradise Recreation & Park District

Master Plan Update 2016 - 2024

July 2016



Prepared by:

 **FOOTHILL ASSOCIATES**

ENVIRONMENTAL CONSULTING • PLANNING • LANDSCAPE ARCHITECTURE

Magalia Park Needs – Statewide Parks Program Community Fact Finder.

- Parks per 1,000 residents: 0.00 acres
- Median Household Income: \$49,811
- Number of People Living in Poverty: 46
- Households Without Access to a Car: 12

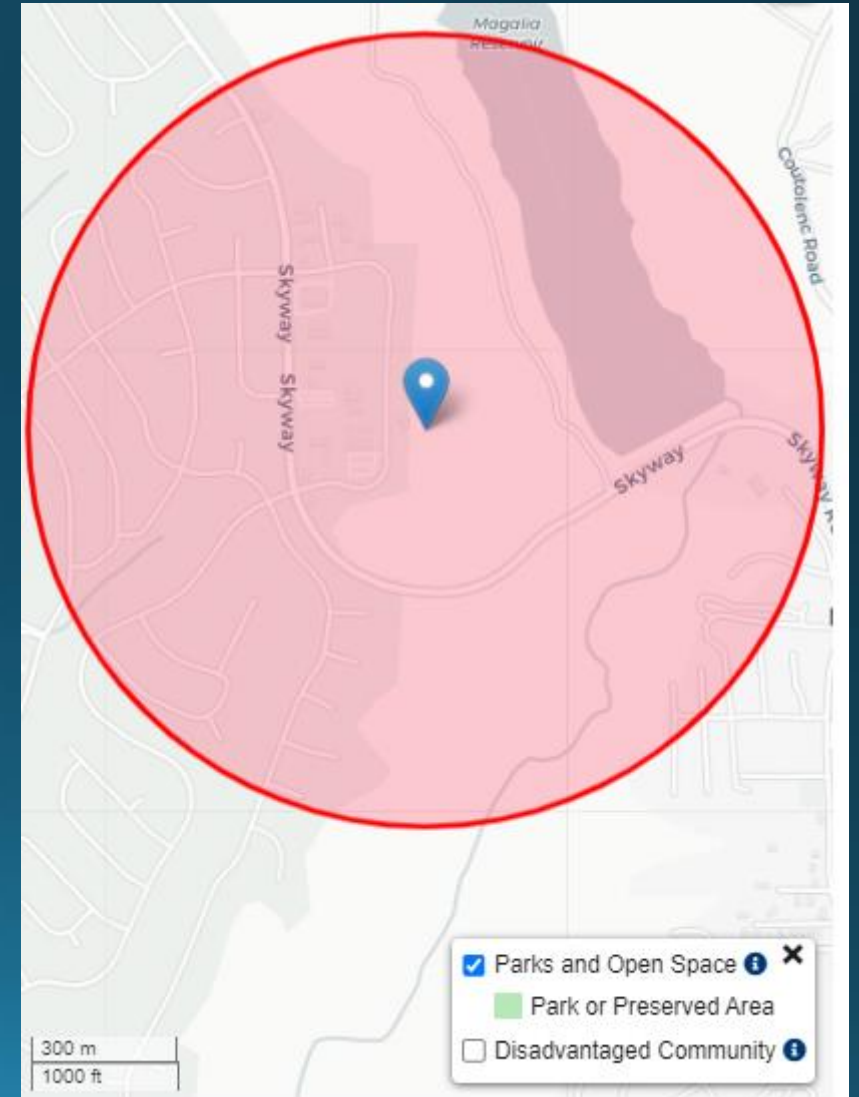

Magalia Park Needs - Summary

Figure 1: Map of 5-, 10- and 15-Minute Drives from the Facility



Figure 2: 2010 Census Data and 2021 & 2026 Forecast Data of People Residing Within a 15-Minute Drive of the Facility

Summary	Census 2010	2021 Forecast	2026 Forecast
Population	32,700	16,329	17,195
Households	14,517	7,165	7,507
Families	9,006	4,531	4,738
Average Household Size	2.23	2.23	2.24
Owner Occupied Homes	10,133	5,178	5,450
Renter Occupied Homes	4,384	1,987	2,057
Median Age	49.5	54.6	55.5
Median Household Income		\$55,433	\$64,262

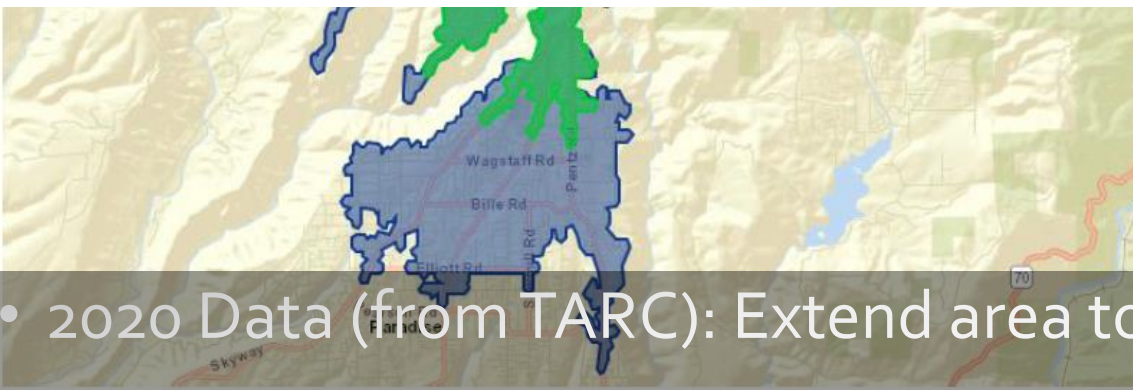

- 2020 Data (from TARC): Extend area to 30-minute drive: **153,315 residents**



Lakeridge Park Magalia

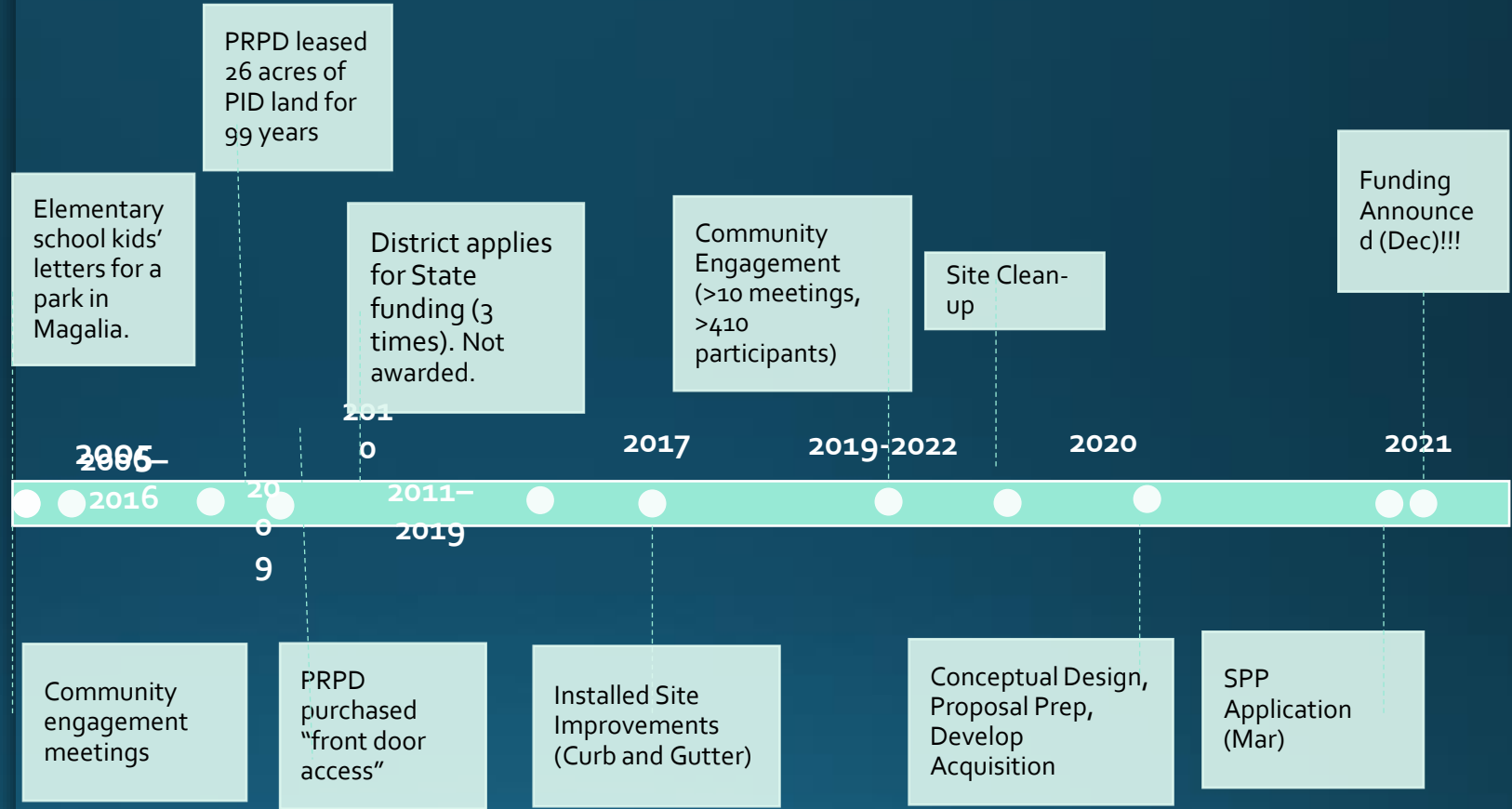

Lakeridge Park



2011

Lakeridge Park

Ready for the Future



Dream Park Design Team



What Kids Want in their Dream Park

- Swings
- Ninja Warrior Course
- Giant Hamster Wheel
- Zip Lines
- Splash Pads
- Pump Track
- Ropes Course
- Slides
- Animal Friendly Park
- Art Sculptures Designed by kids
- Skate/Bike Park
- Snack Shop

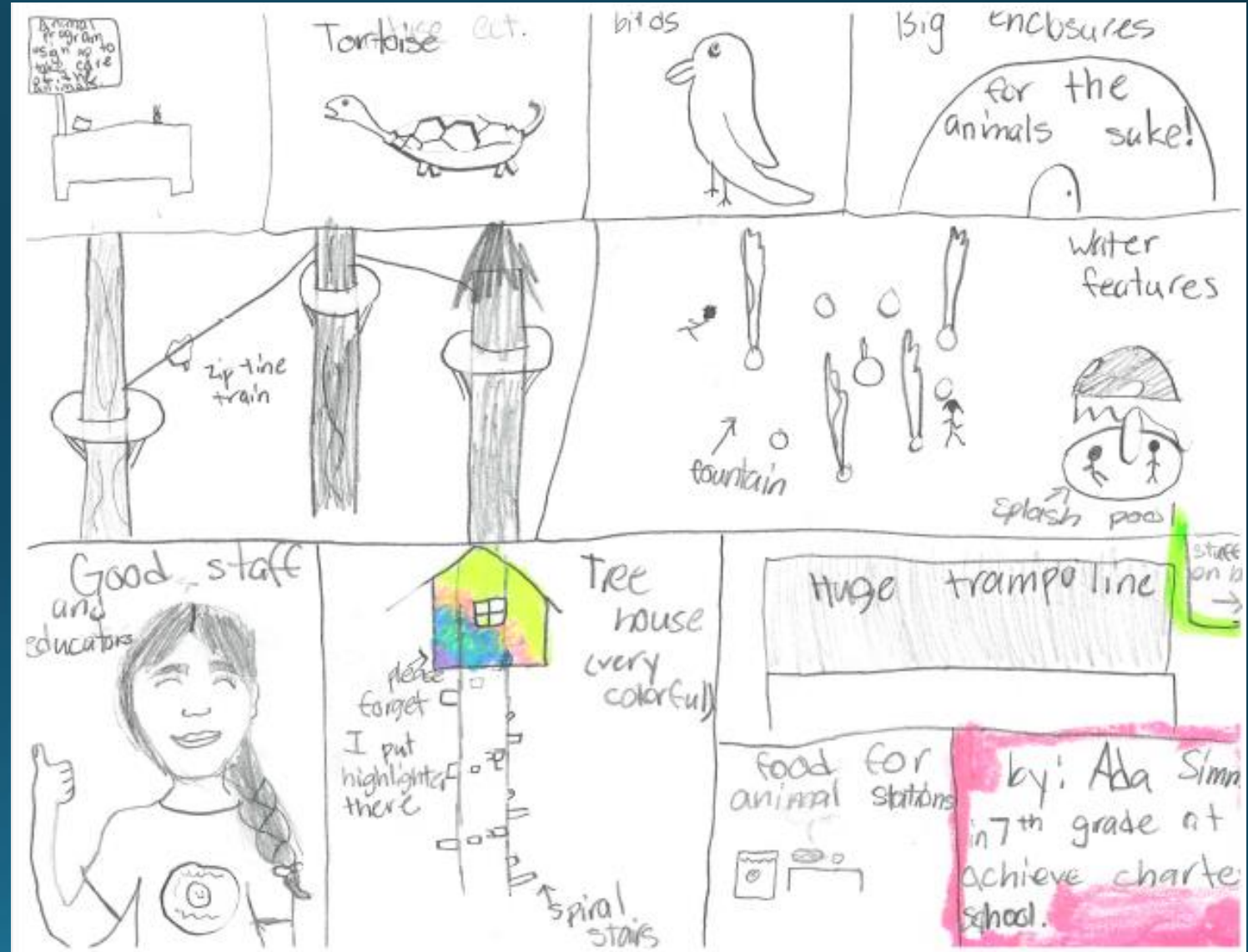

What Adults Asked for at Lakeridge Park

- Group Picnic Sites
- Walking Paths
- Bike and Hiking Trails
- Community Center
- Adventure Park
- Amphitheater
- Splash Pad
- Safe and Clean
- Plenty of Parking



In Support of the Upper Ridge Community Plan

- Economic Development
 - Recreation, Events
- Resiliency
 - Risk Reduction: sound building and landscape practices
 - Shelter-in-place
 - Distribution of services
 - Vegetation Management
- Disaster Readiness
- Multi-modal Transportation
- Connections to Community
 - Meeting space, Connection to trail network
- Multipurpose Park Design
 - Play, Entertainment, Nature Study, Exercise, Passive-Moderate-Active
- Health and Wellness



Lakeridge Park Awarded Funding!

- State Parks Program Grant – Funding Approved for \$5.2M, seeking additional funds for Recreation / Community / Resiliency Center Building
- Community engagement meetings held in Magalia 2007-2016, 2019-2022
- 2009 - PRPD leased 26 acres of PID land for 99 years
- 2010 PRPD purchased front door access to PID land
- Conceptual designs created based on community input meetings
- District applies for State Park Program funding 3 times between 2011-2019 but funding was not awarded
- Over 15 public and school meetings, virtual meetings, design workshops, and surveys (over 50 meetings since 2005...)



Lakeridge Park Awarded Funding!

State Parks Program Grant –

- > 15 public and school meetings, virtual meetings, design workshops, and surveys (over 50 meetings since 2005...)
- Provided input for conceptual design and amenities
- Approved for \$5.2 M, seeking additional funds for Recreation / Community / Resiliency Center Building
- Future Phases

**Parks
Make
Life
Better!**

Amenities

- Multi-Purpose Resiliency Hub and Expanded Community Center (partial funding)
- Overlook with interpretive panels, education, shade structure
- Amphitheater
- Sidewalks, trails and Bike skills course; Multi-use court, Playgrounds / Inclusive Play zip line
- Solar powered security lighting, trash & recycling
- Group & individual picnic shade structure
- Landscaping, Shade trees, shrubs, and turf with biochar.



PROGRAMMING

EDUCATE



ADVENTURE



GATHER



Master Plan

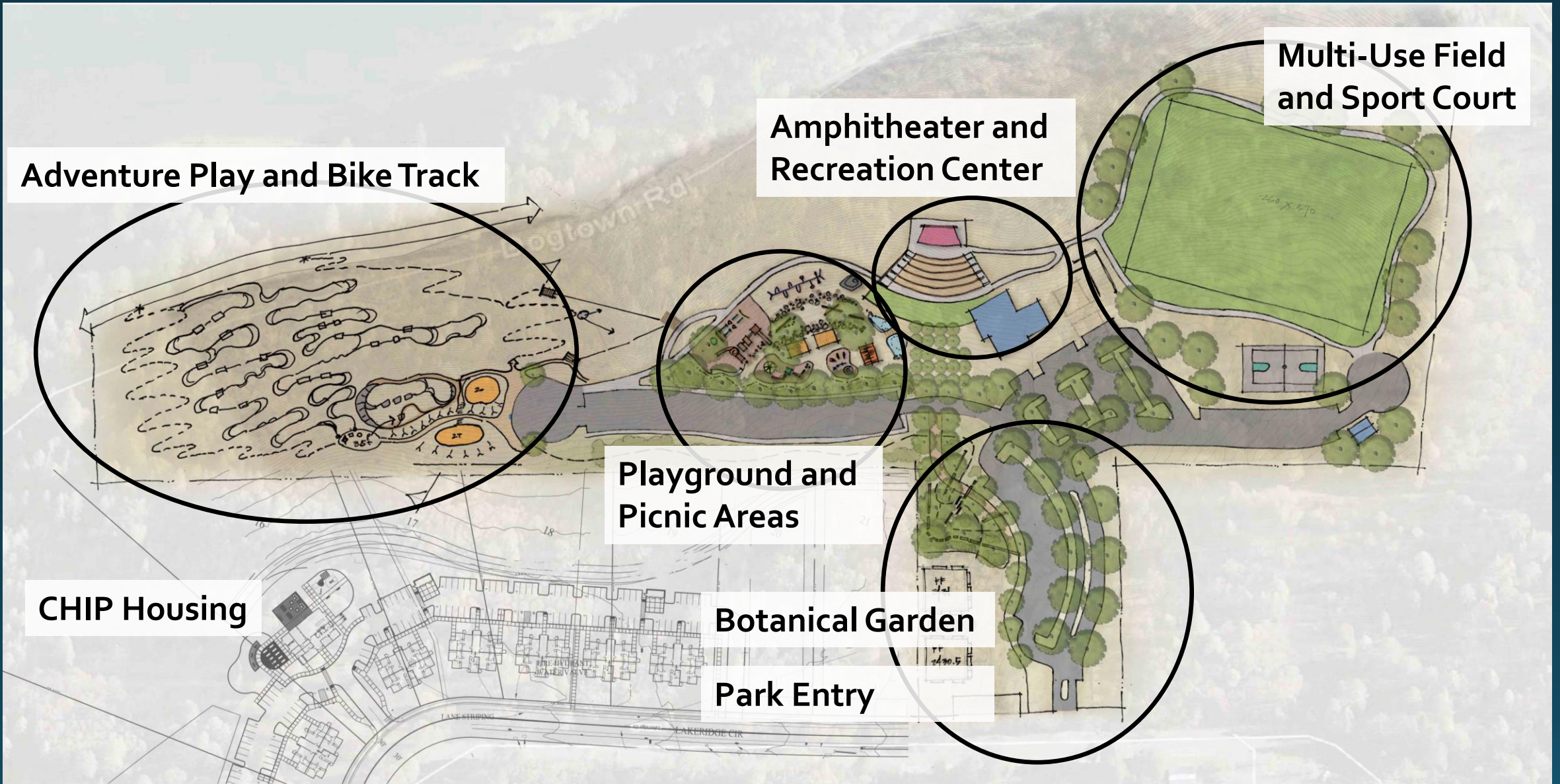

Adventure Play and Bike Track

Amphitheater and Recreation Center

Multi-Use Field and Sport Court

Playground and Picnic Areas

CHIP Housing

Botanical Garden

Park Entry

Entry and Botanical Garden

- Dedicated Pedestrian Trails
- Botanical and Sculpture Garden
- Lakeridge Circle Street Frontage



Adventure Play and Bike Track

- Bike Skills Course
- Adventure Play and Zipline
- Picnic Area
- Walking Trails
- Interpretive Stations

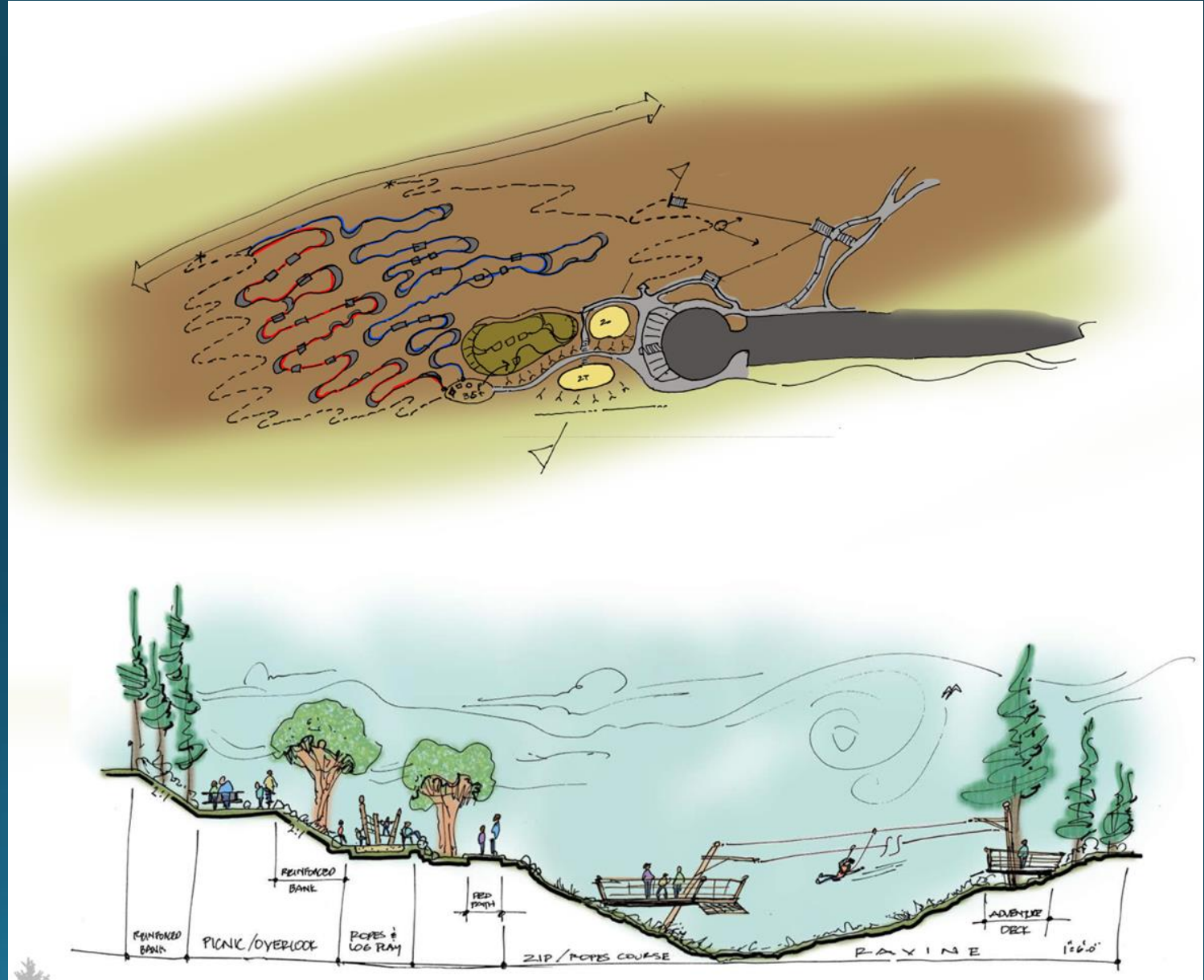

Playgrounds and Picnic Area

- Inclusive Play Areas
- Picnic Area
- Walking Trails
- Water Play - Cooling



MAIN PLAYGROUND



MAIN PLAYGROUND - SECTIONAL



Multi-Use Field and Sport Courts

- Multi-Use Turf Field
- Basketball Court
- Wall Ball
- Walking Trails
- Fitness Stations
- Shelter-in-place
Parking



Recreation Center and Amphitheater

- Recreation Center
 - Events
 - Resiliency Hub
 - Cafe
- Plaza
- Amphitheater
- Picnic Area

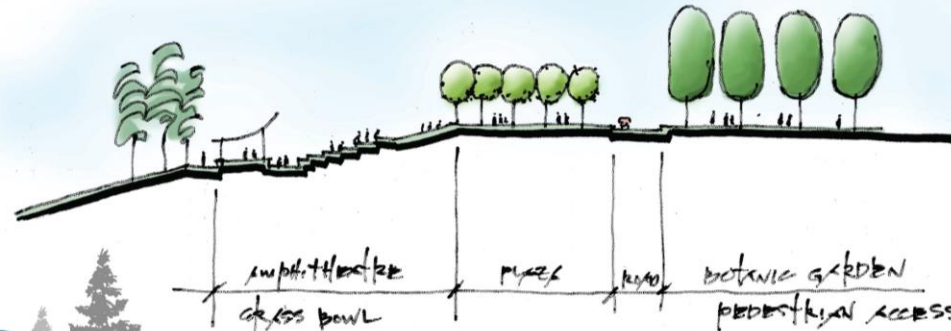
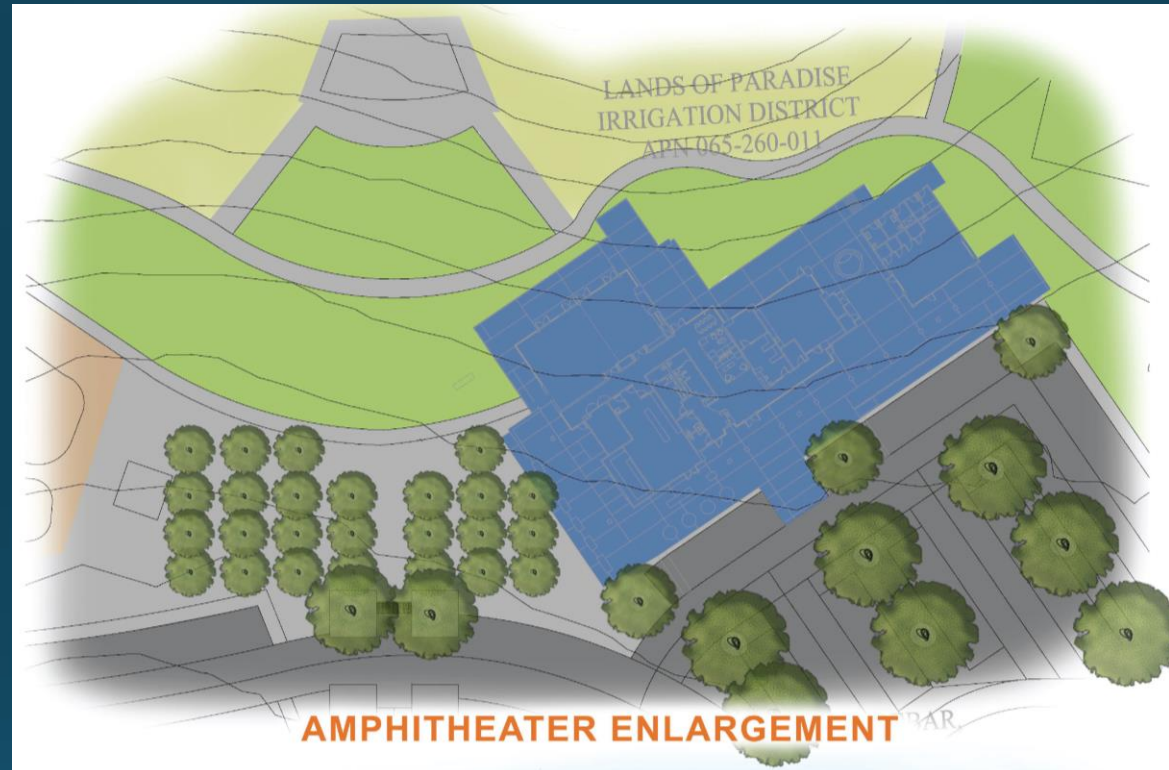

Recreation Center and Multi-Use Field

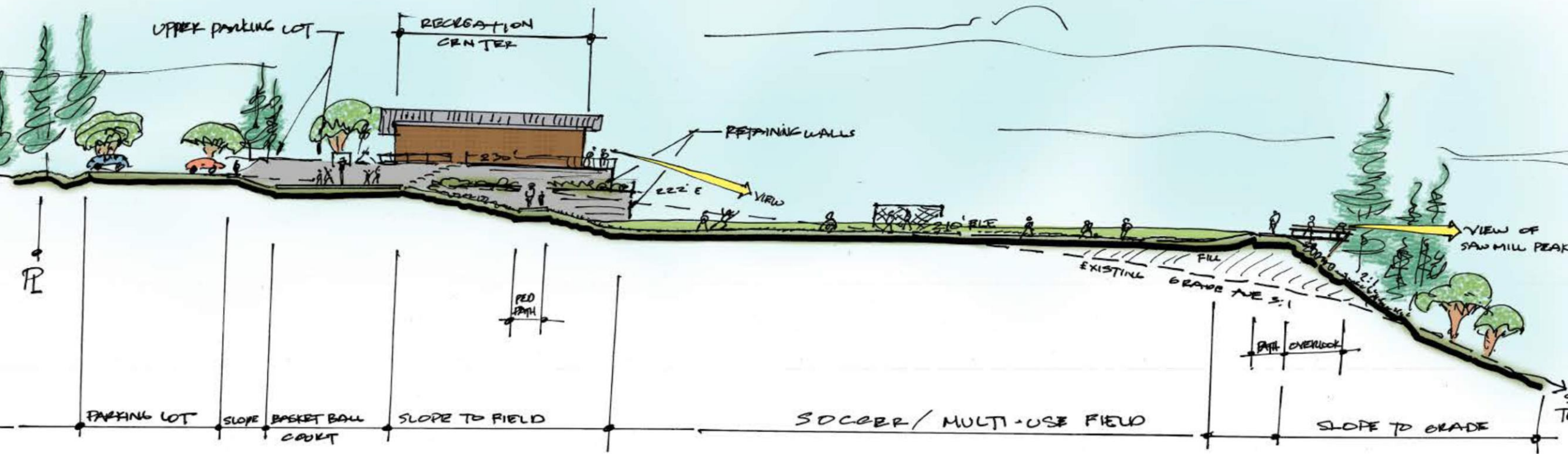

RESILIENT - OPTIONS

Community facilities that provide an additional layer of climate resilience for residents before, during and after extreme weather events and emergencies.

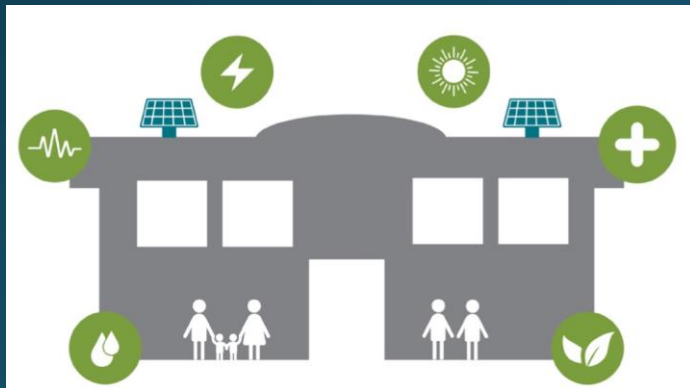

1 FULL SERVICE COMMERCIAL KITCHEN

2 EMERGENCY SHELTER SPACE & SHOWER FACILITIES

3 • BATTERY ENERGY STORAGE
• STAND BY GENERATOR
• WATER STORAGE
• FOOD/SUPPLY STORAGE
• CISTERN (RAIN WATER COLLECTION)

4 SOLAR PANELS WITH BATTERY STORAGE



CHANGE YOUR PERSPECTIVE



THE HUB



ENTRY DRIVE - FRONT DOOR



OPPORTUNITY

Project Timeline

2021

- Site Clearing continues (as funding allows)
- Application (Mar)
- Announcement of Funding (Dec)

2022

- (Upper Ridge Community Plan)
- Agreement (Oct) and Project Start Up
- CEQA
- Acquisition of Lakeridge lot (1.26 acres)!
- Start Design Work



Project Timeline (continued)

MDG will provide more details

2023

- Design work and Partner building
- Explore Additional Funding Sources (facility additions, resiliency features, shop, etc.)
- Fall 2023 – Site clearing, survey, groundwork

2024

- Construction initiates
- Trails grant construction

2026

- Portions of Park (playground, picnic sites, etc.) open

2028

- Completion of grant (Phasing may allow for park to open before building)
- Programming expands

Schedule

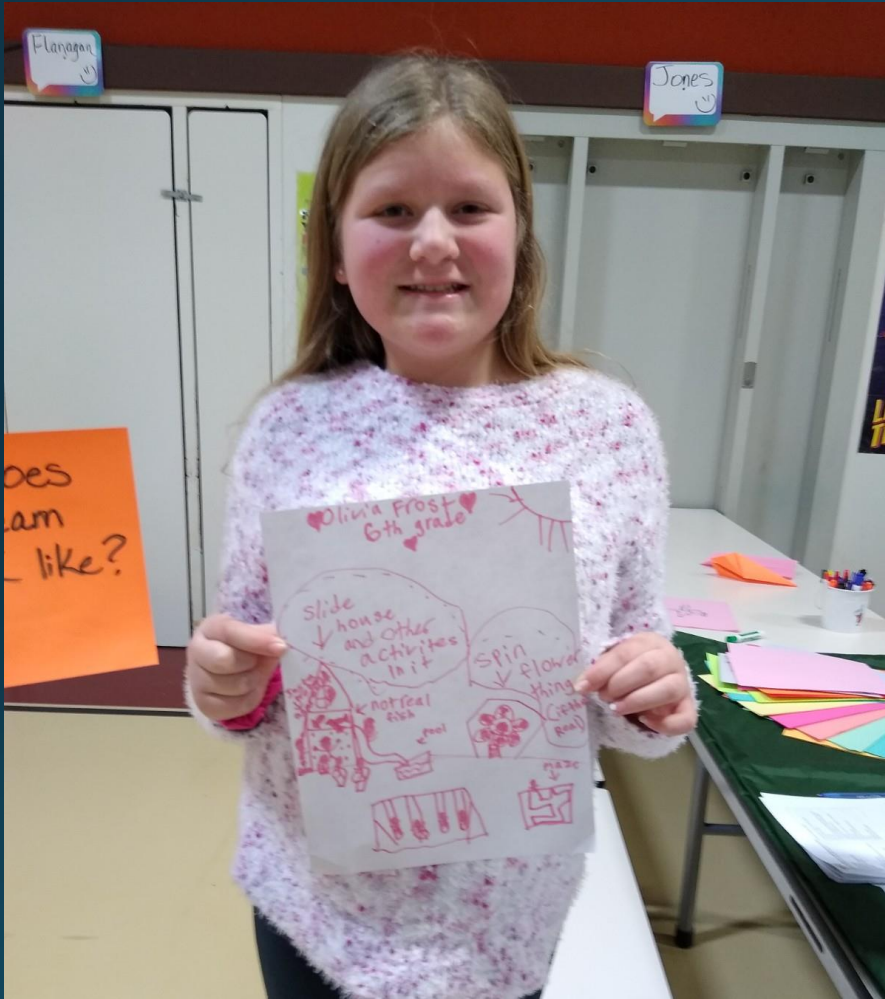

From A Child's Request to a developed park



2005

Students from Cedarwood Elementary write to the District Asking for a park in Magalia

Launched Public Outreach Campaign

2006



2010

Park Land purchased/leased in Magalia.

Grant Funding Awarded

2021



2024

Construction begins

Lakeridge Park Ribbon Cutting

2028





Parks improve life for the people living here today and for generations to come.

Questions?

Dan Efseaff, District Manager

530-872-6393, info@paradisepripd.com

